



27 LOWELL STREET | SUITE 503  
 MANCHESTER, NH 03101  
 TEL 603-836-5660  
 FAX 603-836-5661  
 WEB www.fsmdrawings.com  
 EMAIL info@fsmdrawings.com

# THE Thorndike

**52' x 28' CAPE STYLE HOME**  
 (Approximate Overall Footprint Dimension)

A 52' x 28' Cape Style 3 Bedroom Home offering 2 1/2 Baths, Eat-in Kitchen, and Family Room with Cathedral Ceiling

First Floor Laundry & Drive-Under Garage

This Home offers a First Floor Master Suite, 3-Seasons Room and plenty of Closet space

2x6 Wall Construction ready for 2009 IECC Energy Code Standards

Designed for a Ground Snow Load of 70 lb/ft<sup>2</sup>  
 (Can be adjusted to meet IBC Standards)

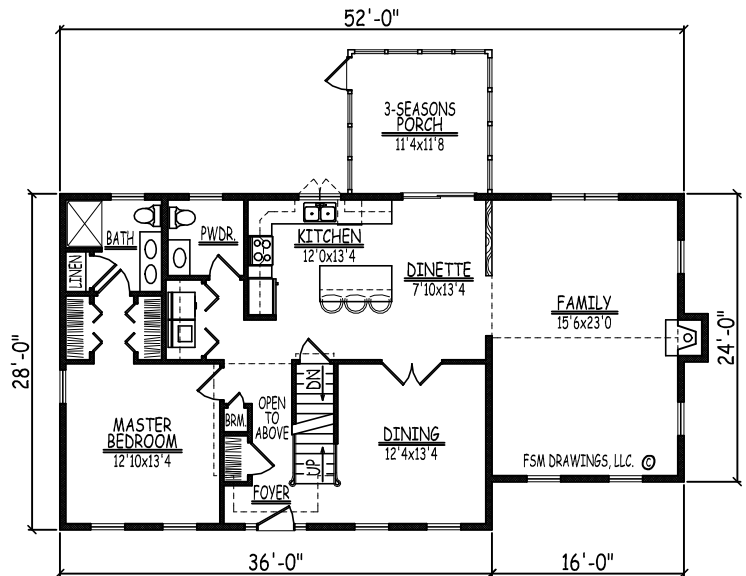

FIRST FLOOR PLAN

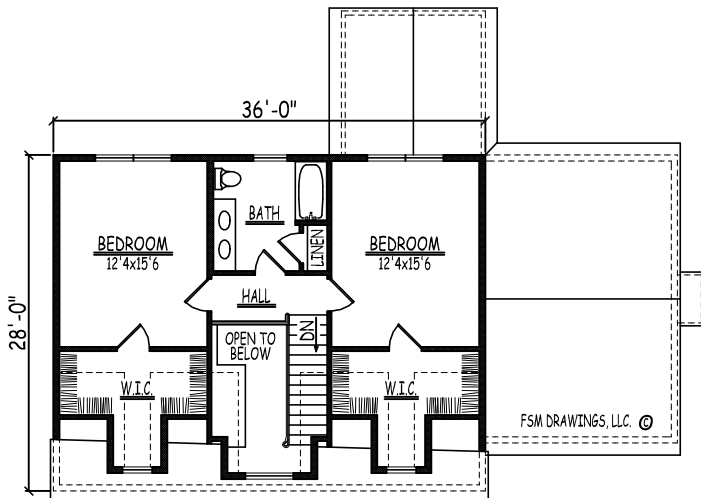

SECOND FLOOR PLAN

## SQUARE FOOTAGE TABLE

(TOTALS EXCLUDE UNFINISHED/STORAGE & GARAGE)

PLAN	SQ. FTG.
FIRST FLOOR	1,392
SECOND FLOOR	761
<b>TOTAL:</b>	<b>2,153</b>
3-SEASONS PORCH	144

NOTES: FOR PLAN # 11134CA